

РУКОВОДСТВО ПО СБОРКЕ

ASSEMBLY INSTRUCTIONS

INSTRUCCIONES DE MONTAJE

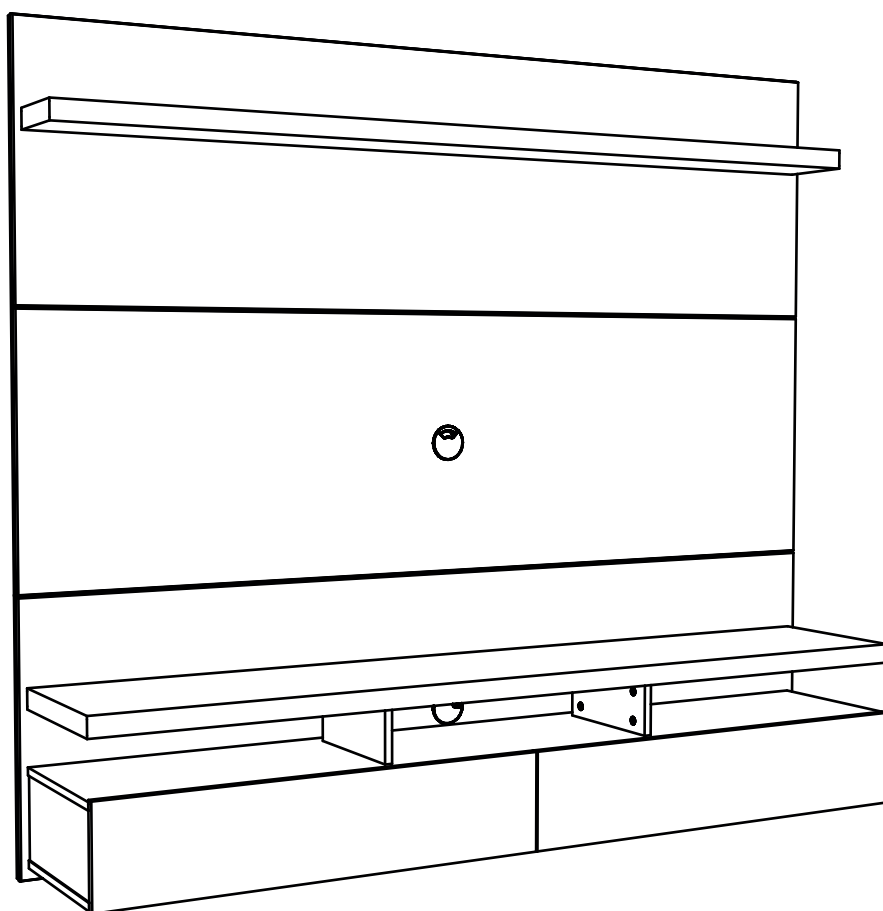

АРТИКУЛ: 25300

НАКЛЕЙКА/
СТИКЕР
STICKER
ADHESIVO

COD. 4462

COD. 1668

COD. 9070

COD. 4157

COD. 2511

ПРОВОДНОЙ КАНАЛ
WIRE CHANNEL
PASAJE DE ALAMBRE

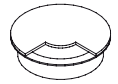
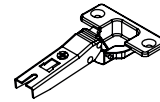
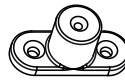
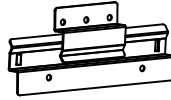
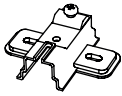
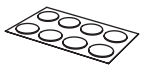

A

B

C

D

E

F

G

COD. 0348

COD. 2088

COD. 0494

COD. 0599

COD. 0160

COD. 3557

COD. 3706

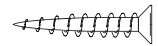

H

I

J

K

L

M

N

COD. 3527

COD. 4762

COD. 7519

COD. 6244

COD. 4505

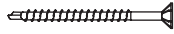

O

P

Q

R

S

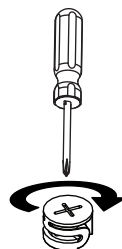

ОПИСАНИЕ/DESCRIPTION/DESCRIPCIÓN

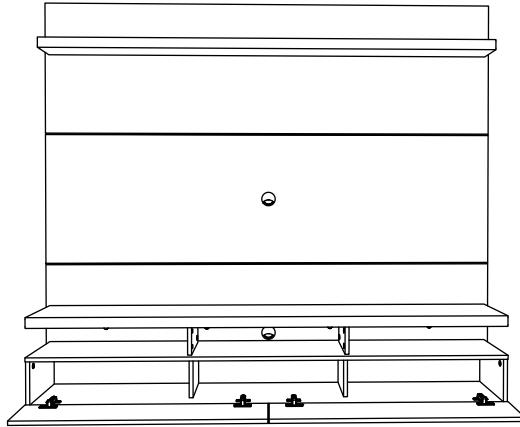

Ш:1600мм В:1611мм Г:388мм
 W:62.99in H:63.43in D:15.28in
 L:1600mm A:1611mm P:388mm

АТИКУЛ:25300

| № ДЕТАЛИ PART PIEZA | КОЛИЧЕСТВО QUANTITY CANTIDAD | ОПИСАНИЕ | DESCRIPTION | DESCRIPCIÓN | КОРОБКА BOX CAJA |
|---------------------------|------------------------------------|----------------------------|--------------------|-------------------------|------------------------|
| 03 | 01 | ВЕРХНЯЯ ПОЛКА | TOP SHELF | ESTANTE | 01 |
| 10 | 01 | ВЕРХНЯЯ ПАНЕЛЬ | TOP PANEL | PANEL SUPERIOR | 01 |
| 11 | 01 | ПАНЕЛЬ С ПРОВОДНЫМ КАНАЛОМ | WIRE CHANNEL PANEL | PANEL PASAJE DE ALAMBRE | 01 |
| 13 | 02 | БОКОВАЯ РЕЙКА | SIDE BATTEN | SOPORTE LATERAL | 01 |
| 22 | 01 | ВЕРХНЯЯ ДОСКА | TOP BOARD | CUBIERTA SUPERIOR | 02 |
| 23 | 01 | ЦЕНТРАЛЬНАЯ ДОСКА | CENTER BOARD | CUBIERTA CENTRAL | 02 |
| 24 | 01 | НИЖНЯЯ ДОСКА | BOTTOM BOARD | CUBIERTA INFERIOR | 02 |
| 25 | 02 | ВЕРХНИЕ ПЕРЕГОРОДКИ | SIDE TOP | LATERAL SUPERIOR | 01 |
| 26 | 02 | НИЖНИЕ ПЕРЕГОРОДКИ | SIDE BOTTOM | LATERAL INFERIOR | 01 |
| 27 | 01 | ЛЕВАЯ БОКОВИНА | LEFT SIDE | LATERAL IZQUIERDA | 01 |
| 28 | 01 | ПРАВАЯ БОКОВИНА | RIGHT SIDE | LATERAL SUPERIOR | 01 |
| 32 | 02 | ДВЕРЦА | DOOR | PUERTA | 01 |
| 33 | 01 | ЗАДНЯЯ ПАНЕЛЬ | BACK PANEL | PANEL TRASERO | 01 |
| 34 | 02 | РЕЙКА | BATTEN | SOPORTE | 01 |

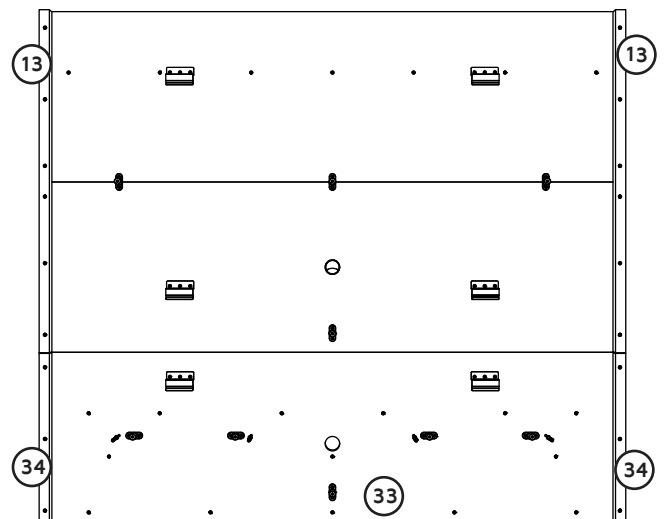
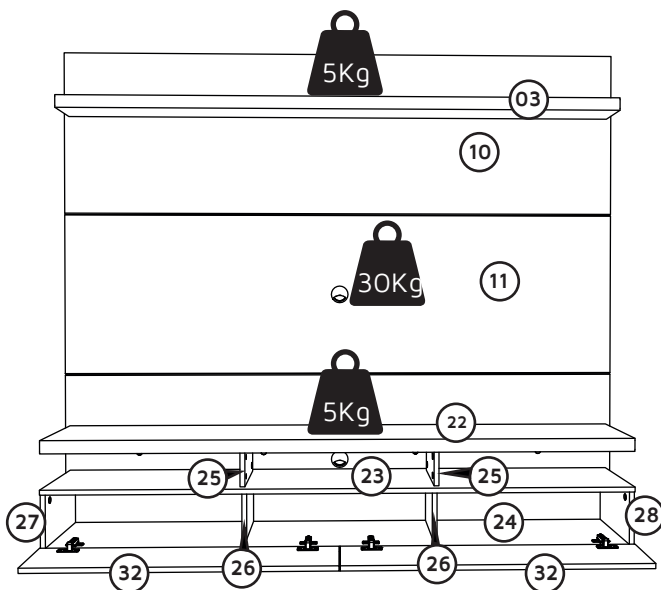

 30Kg = 66Lb
 5Kg = 11Lb

01

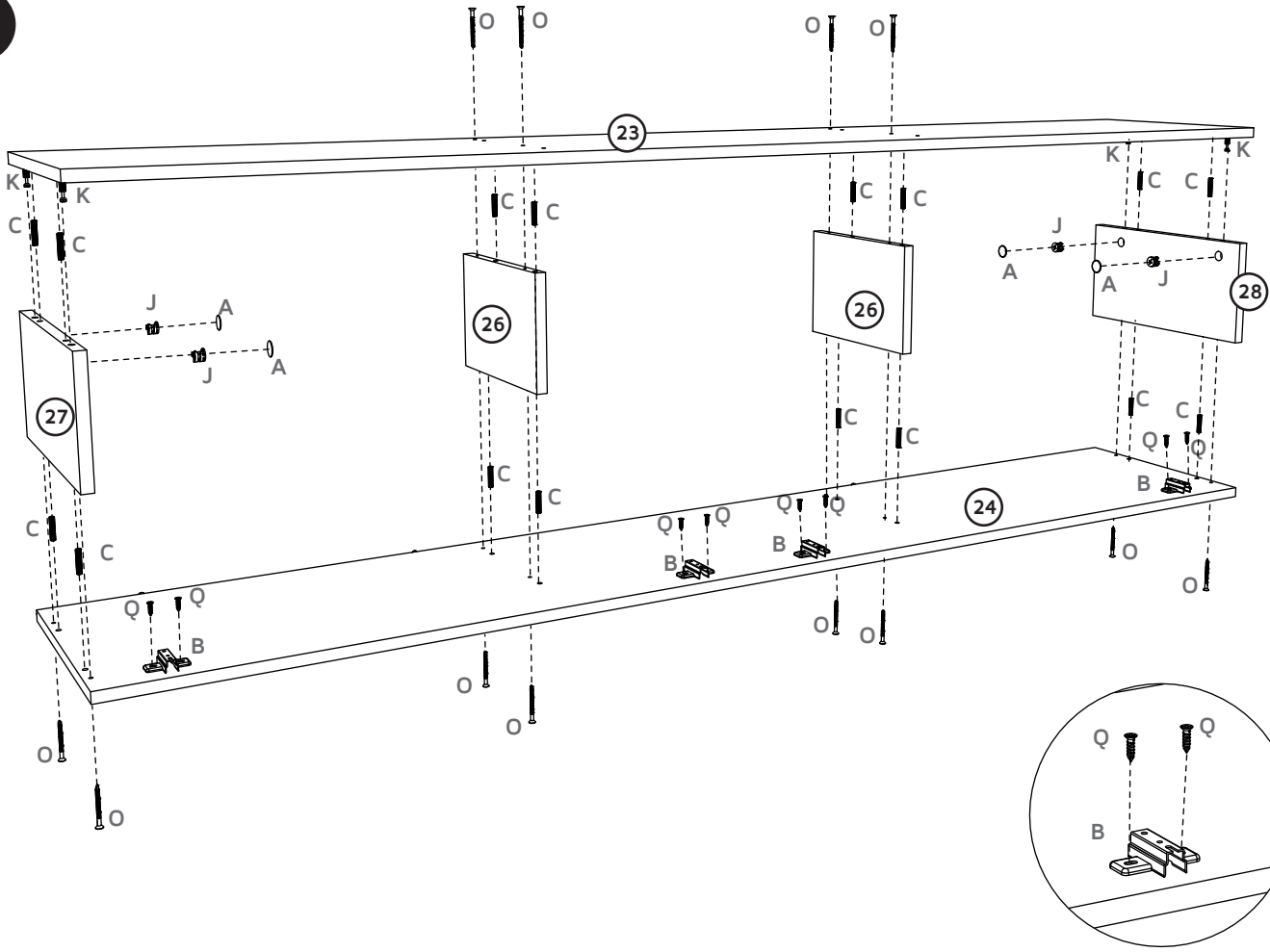

02

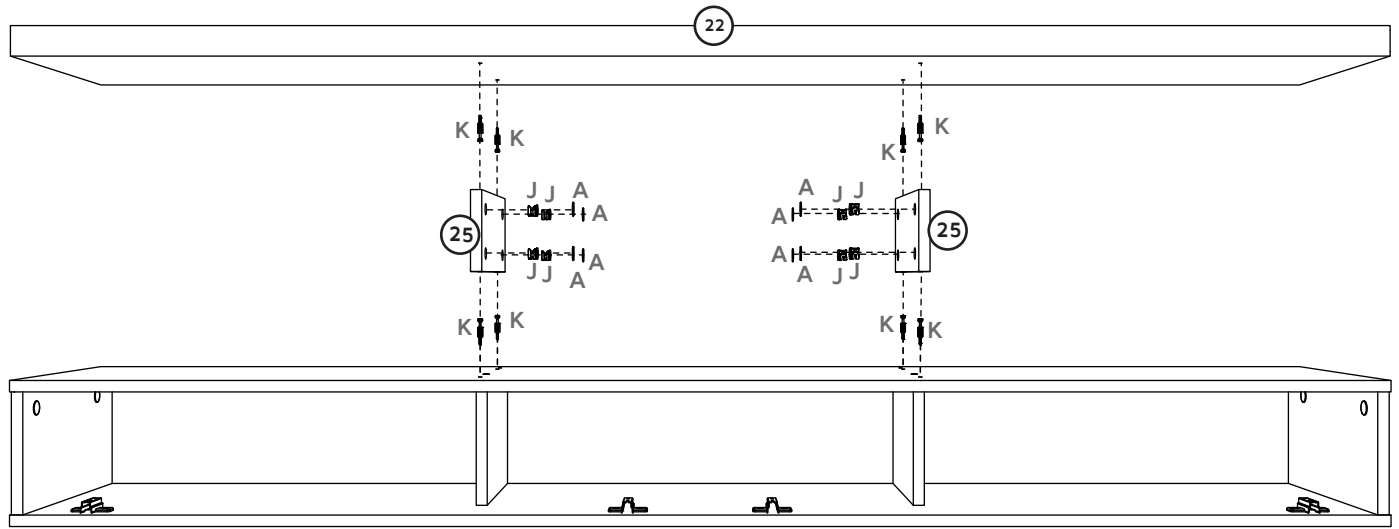

03

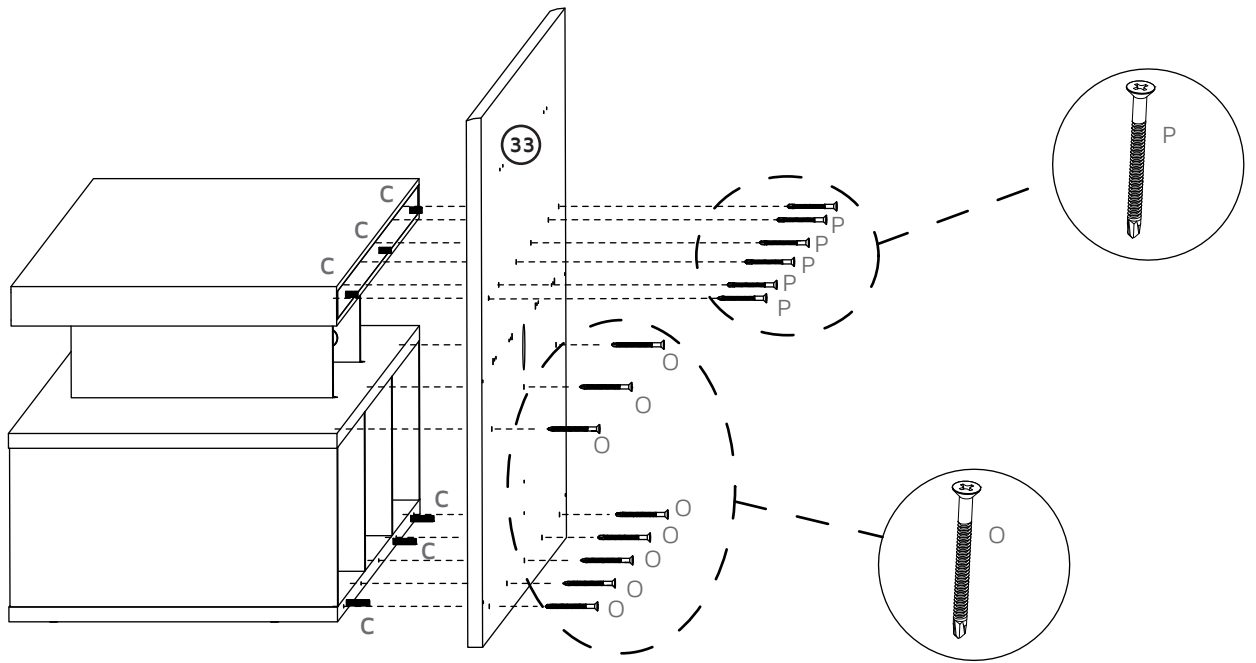

04

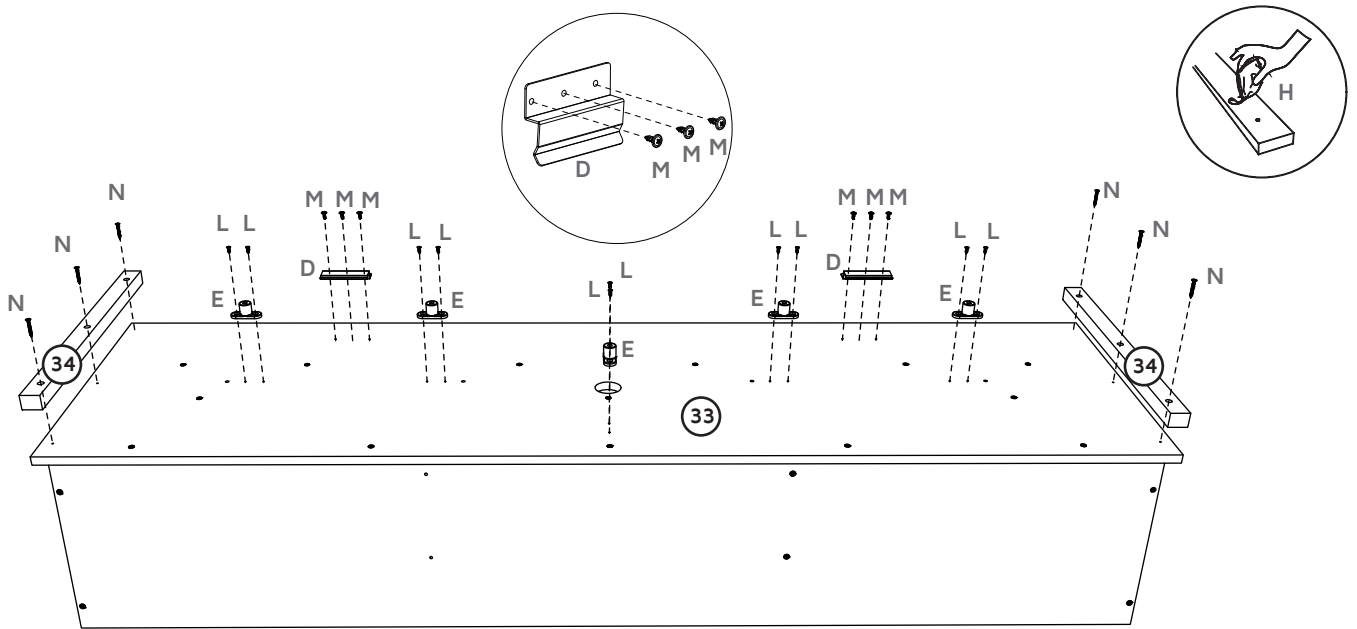

05

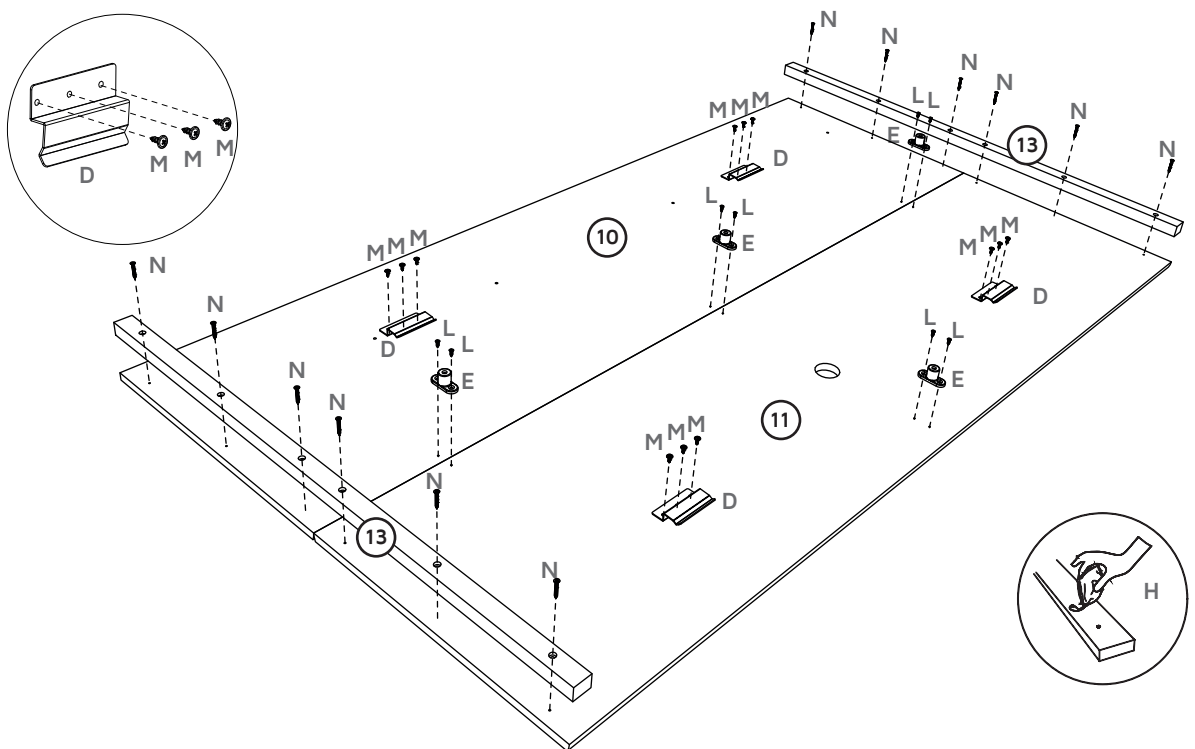

06

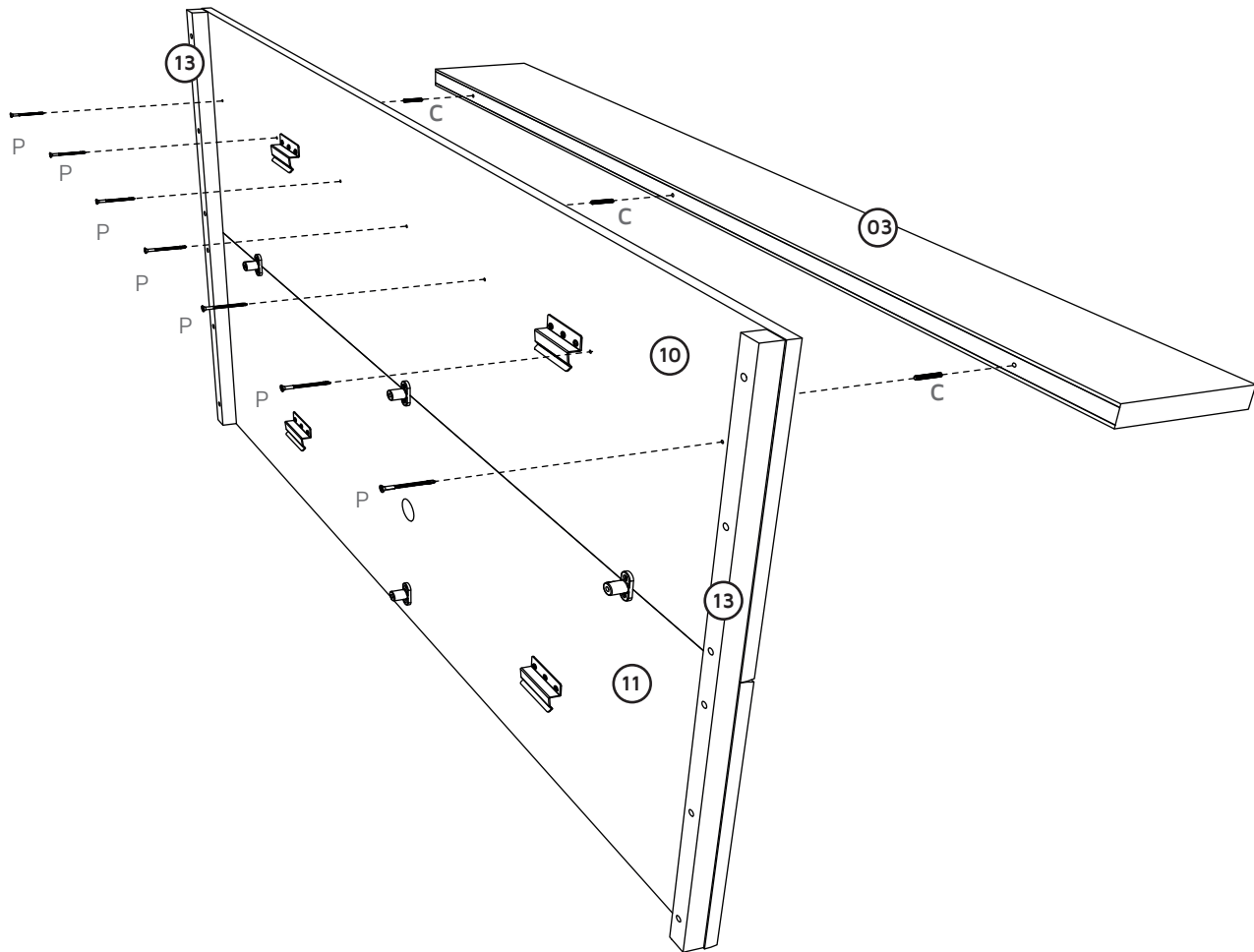

07

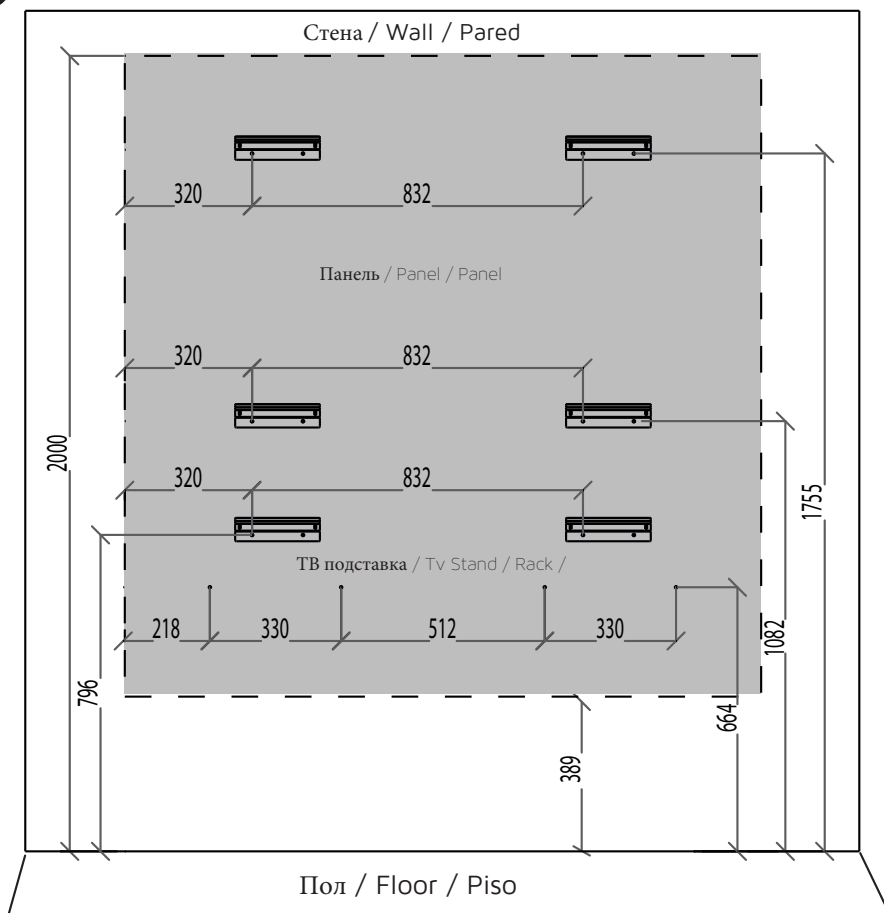

Размеры для сверления стены
(в миллиметрах).
Measurement to drill the wall
(in millimeters).
Medidas para realizar la perforación de la
pared (en milímetros).

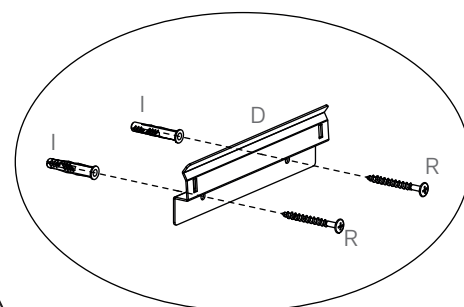
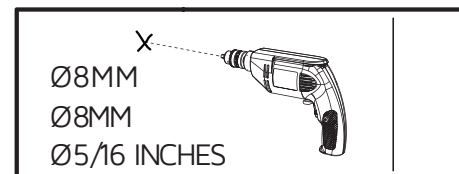
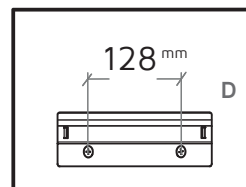

08

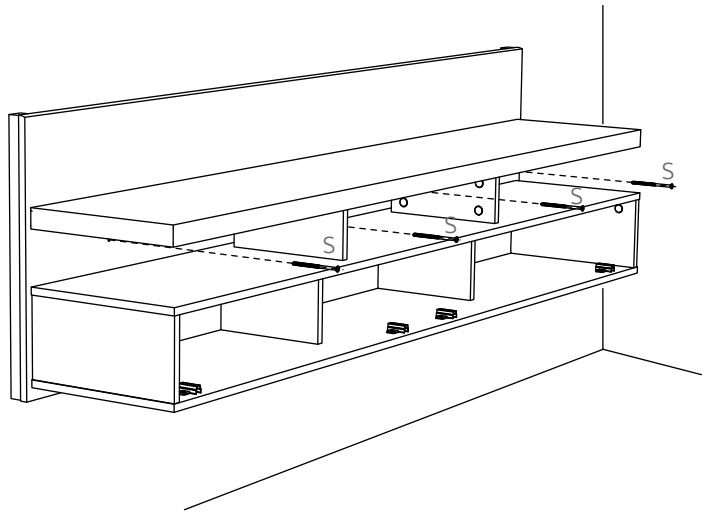
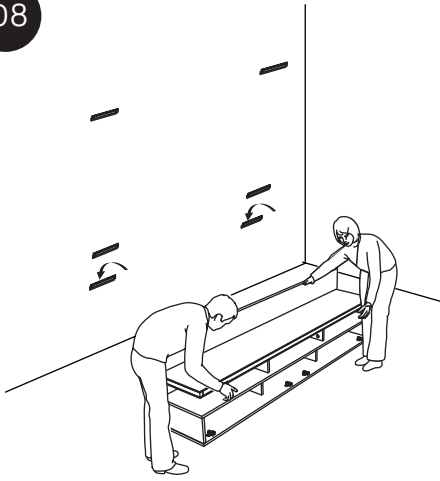

Пропустите кабели через заднюю часть панели перед ее закреплением.

Pass the cables through the back before Panel.
Lleve el cables antes de encajar el panel.

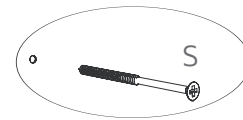
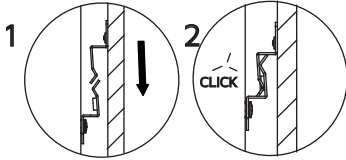

ПРЕДОХРАНИТЕЛЬНЫЙ ВИНТ
SAFETY SCREW TORNILLO DE
SEGURIDAD VIS DE SÉCURITÉ

Перед завинчиванием пропустите кабели через проводной канал (S).

Pass the cables through the wire channel before screwing (S).
Lleve el cables antes atornillar (S).

09

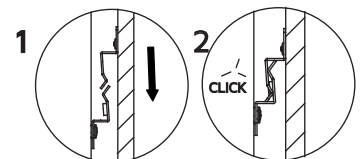
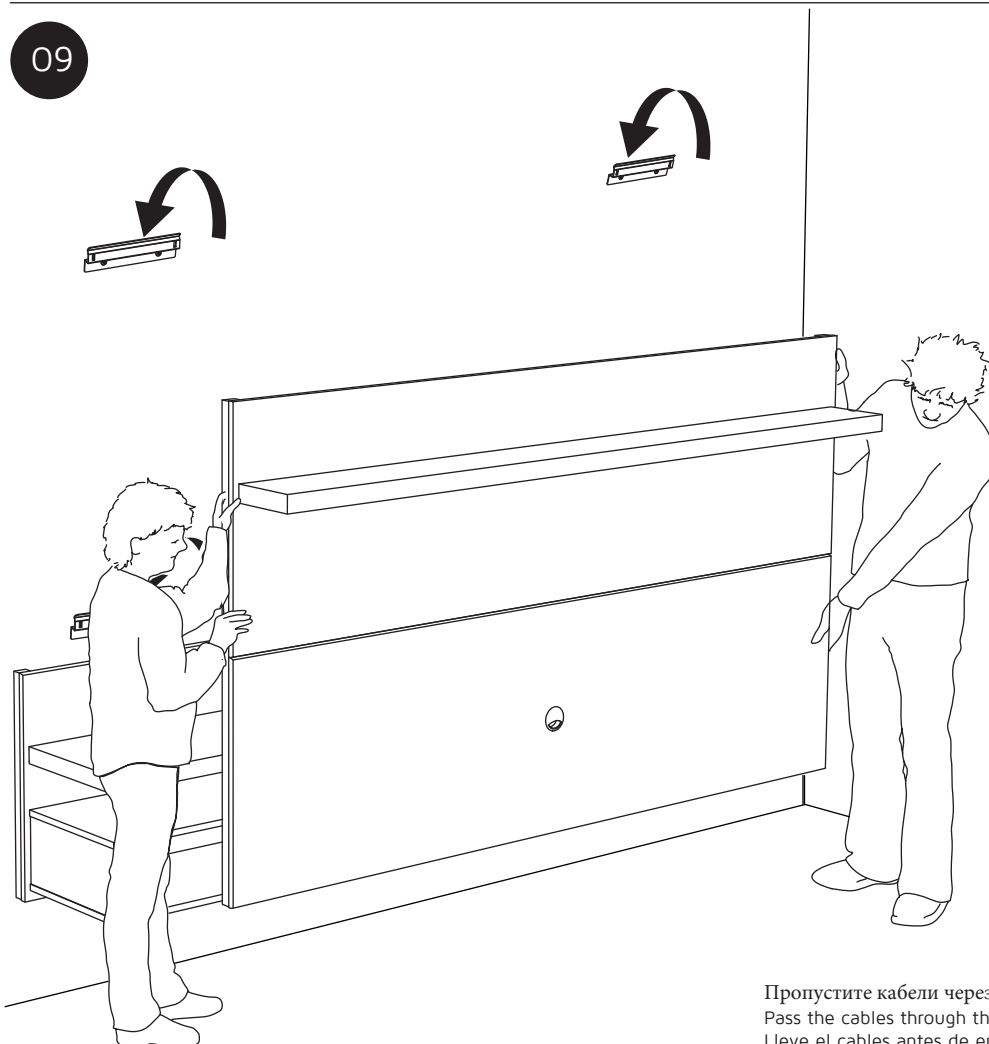

Пропустите кабели через заднюю часть панели перед ее закреплением.
Pass the cables through the back before Panel.
Lleve el cables antes de encajar el panel.

